

AVK Series 766 Butterfly Valve Exploded Parts Breakdown 24-inch through 48-inch

Components:

- 801. Body
- 805. Drive Shaft
- 806. Stub Shaft
- 807. Disc Body
- 810. Gearbox Key
- 811. Gearbox
- 812. Hand Wheel
- 814. Gearbox Bolt
- 815. Gearbox Washer
- 816. Hand Wheel Screw
- 821. Axial Bearing
- 825. End Plate
- 826. End Plate Washers
- 827. End Plate Bolts
- 836. Upper O-ring Retainer Screws
- 837. Upper O-ring Retainer Inner O-rings
- 838. Upper O-ring Retainer Outer O-rings
- 839. Upper O-ring Retainer Safety Key
- 843. End Plate Dust O-ring
- 845. Pin Screw
- 846. Pin Lock Washer
- 847. Outer Pin O-ring
- 848. Pin Safety Plate
- 849. Pin Washer
- 850. Inner Pin O-ring
- 851. Disc Pin
- 852. Wrench Nut
- 853. Wrench Nut Key
- 854. Wrench Nut Set Screw
- 855. Axial Bearing O-ring
- 856. Axial Thrust Bearing Gasket
- 857. Axial Thrust Bearing Mounting Screws
- 858. Axial Thrust Bearing Adjustment Screws
- 859. Axial Thrust Bearing Lower O-ring Retainer Mounting Screws
- 860. Lower O-ring Retainer Inner O-rings
- 861. Lower O-ring Retainer Lower O-ring Retainer Lower O-ring Retainer Outer O-rings
- 864. Seat Mounting Screws
- 865. Seat Ring
- 866. Seat Ring O-ring
- 867. Disc Cover O-ring
- 868. Disc Cover Gasket
- 869. Disc Cover

Components:

- 870. Disc Cover Mounting Screws
- 871. Disc Seal Retainer O-ring
- 872. Disc Seal
- 873. Disc Seal Retainer Mounting Screw O-rings
- 874. Disc Seal Retainer
- 875. Disc Seal Retainer Mounting Screw Washers
- 876. Disc Seal Retainer Mounting Screws

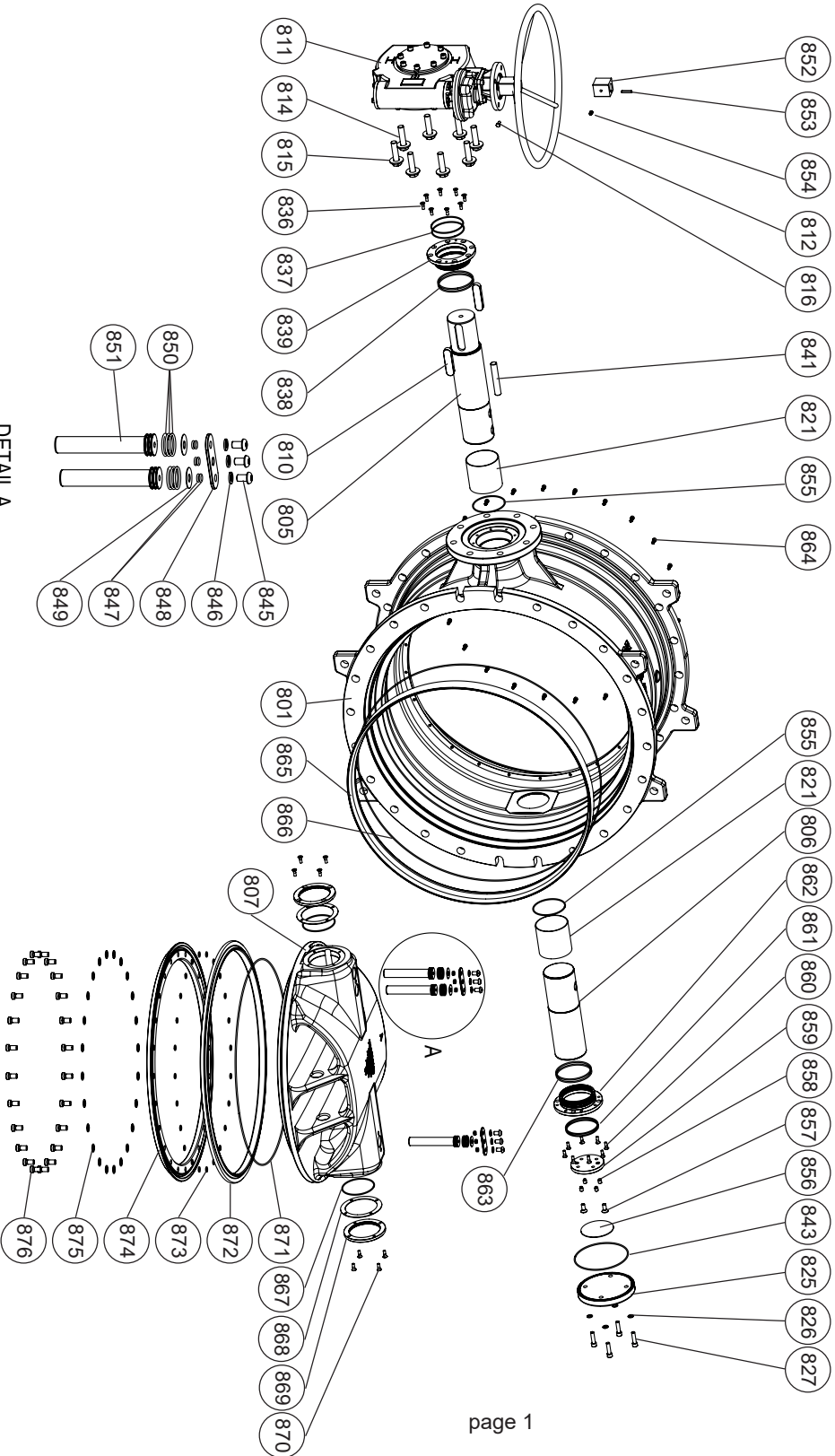

DETAIL A
SCALE 1 : 10

Item No.	Description	Material
801	Body	Ductile iron, ASTM A536
805	Drive Shaft	431 Stainless steel
806	Stub Shaft	431 Stainless steel
807	Disc Body	Epoxy coated ductile iron, ASTM A536
810	Gearbox Key	304 Stainless steel
811	Gearbox	N/A
812	Hand Wheel	Mild Steel
814	Gearbox Bolt	304 Stainless steel
815	Gearbox Washer	304 Stainless steel
816	Hand Wheel Screw	304 Stainless steel
821	Axial Bearing	Steel with PTFE
825	End Plate	Ductile iron, ASTM A536
826	End Plate Washers	304 Stainless steel
827	End Plate Bolts	304 Stainless steel
836	Upper O-ring Retainer Screws	304 Stainless steel
837	Upper O-ring Retainer Inner O-rings	EPDM NSF61
838	Upper O-ring Retainer Outer O-rings	EPDM NSF61
839	Upper O-ring Retainer	Aluminum Bronze
841	Safety Key	431 Stainless steel
843	End Plate Dust O-ring	NBR
845	Pin Screw	304 Stainless steel
846	Pin Lock Washer	304 Stainless steel
847	Outer Pin O-ring	EPDM NFS61
848	Pin Safety Plate	304 Stainless steel
849	Pin Washer	Zinc
850	Inner Pin O-ring	EPDM NFS61
851	Disc Pin	431 Stainless steel
852	Wrench Nut	Ductile iron, ASTM A536
853	Wrench Nut Key	304 Stainless steel
854	Wrench Nut Set Screw	304 Stainless steel
855	Axial Bearing O-ring	NBR
856	Axial Thrust Bearing Gasket	NBR
857	Axial Thrust Bearing Mounting Screws	304 Stainless steel
858	Axial Thrust Bearing Adjustment Screws	304 Stainless steel
859	Axial Thrust Bearing	304 or 316
860	Lower O-ring Retainer Mounting Screws	304 Stainless steel
861	Lower O-ring Retainer Inner O-rings	NBR
862	Lower O-ring Retainer	Aluminum Bronze
863	Lower O-ring Retainer Outer O-rings	NBR
864	Seat Mounting Screws	304 Stainless steel
865	Seat	304 or 316
866	Seat O-ring	NBR
867	Disc Cover O-ring	NBR
868	Disc Cover Gasket	NBR
869	Disc Cover	420 or 316
870	Disc Cover Mounting Screws	304 Stainless steel
871	Disc Seal Retainer O-ring	NBR
872	Disc Seal	EPDM
873	Disc Seal Retainer Mounting Screw O-rings	NBR
874	Disc Seal Retainer	316 Stainless steel
875	Disc Seal Retainer Mounting Screw Waashers	304 Stainless steel
876	Disc Seal Retainer Mounting Screws	304 Stainless steel